



fancort industries, inc. TM

Model FF-400A

Overview

Recirculating fume extraction is now extremely important with the rising concern for our environment and employee safety. Fancort Fume Extractors provide not only a flexible and portable process for plant redesigns and expansions, but also a more stable process by providing a controlled airflow to remove harmful fumes. All this while eliminating the added costs of building modifications, increased air handling systems.

Features

- ▶ Automatic Flow Control maintains constant extraction rate.
- ▶ Adjustable Air Flow extends filter life.
- ▶ Blocked Filter Warning.
- ▶ Easy to change filters.
- ▶ Low energy consumption.
- ▶ Quiet operation.
- ▶ Welded stainless steel construction.
- ▶ Reverse Air Flow prevents condensation and extends filter life.
- ▶ Continuous run brushless motors.
- ▶ HEPA filtration removes 99.997% of particles down to .3 microns.
- ▶ Gas and particle sensors on exhaust.
- ▶ Filter Blocked Monitor.
- ▶ Remote Machine Interface.



Model FF-400A

Power Switch w/
Indicator Light

Variable Speed
Control



Filter Status
Indicator



fancort industries, inc. TM

Model FF-400A

FF-400A Volume Control

| Pre-Filter Options | | |
|---|----------------------------|--------|
|  | Pre-filter Pad (Pack of 4) | 202269 |
| | Pleated Bag Filter | 202274 |

| Main Filter Options | | |
|---|-------------------------|--------|
|  | HEPA/Chemical (std) | 113505 |
| | HEPA/Twin Chemical | 113579 |
| | HEPA/Chemical Cleanroom | 113512 |
| | HEPA | 113809 |
| | Chemical | 113508 |

| | FF-400A | |
|---------------------|----------------------------------|------------|
| | OAL4103 | OAL4102 |
| Model | | |
| Voltage (50hz/60hz) | 120v (1ph) | 230v (1ph) |
| Wattage | .255 kW | .24 kW |
| Airflow | 235 cfm (400 m ³ /Hr) | |
| Vacuum | 16 inwg (4 kPa) | |
| Air Inlet | 80mm Safe Seal | |
| Sound Rating | 45 dBA | |
| Dimensions (L/W/H) | 18.5 in x 17 in x 35 in | |
| Weight | 121.25 lbs | |

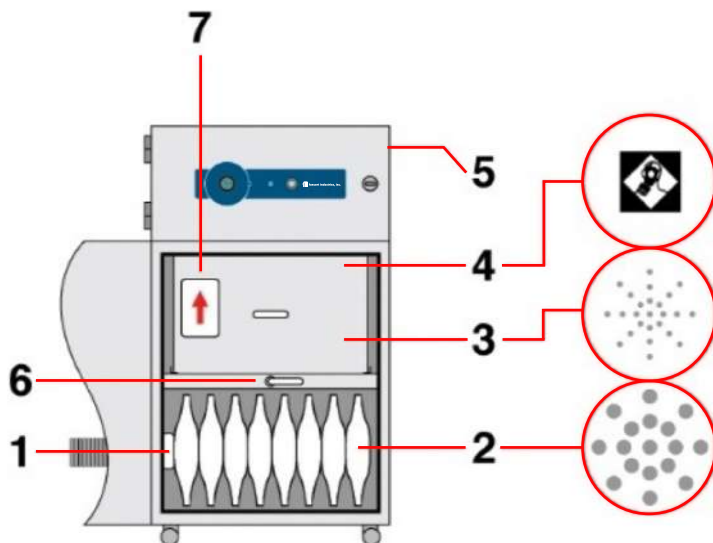

- 1) Dual Air inlet.
- 2) Pre-filter.
- 3) Main filter (HEPA Location).
- 4) Main filter (Carbon Location).
- 5) Clean air return.

www.fancort.com
 31 Fairfield Place West Caldwell, NJ 07006
sales@fancort.com
 (P) 1.888.FANCORT
 (P) 973.575.0610