

Quad Pack Specification Sheet

PACKAGE TYPE:

FOOT CONFIGURATION:

FA / FS NUMBER _____
 MANUFACTURER MICROSEMI CORP
 PART NUMBER RT4G150- CQ352
 DATE _____
 DRAWN BY _____

TOP BRAZE

X

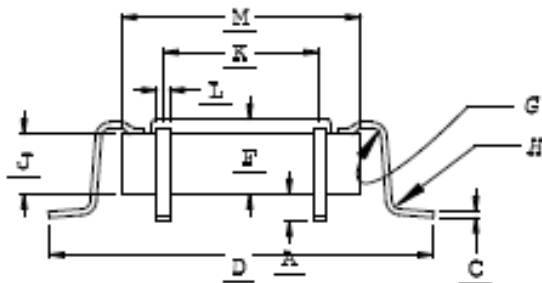

OPTION 1

X

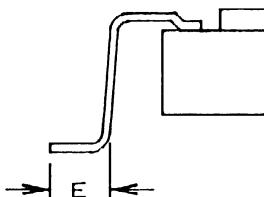

SIDE EXIT

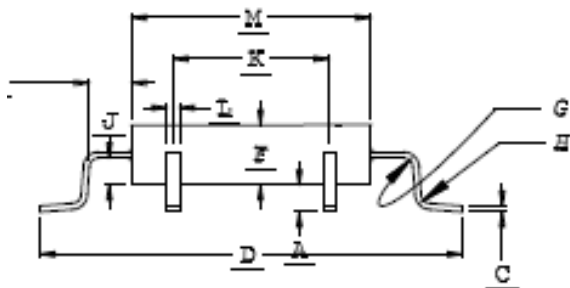

OPTION 2

(JEDEC)

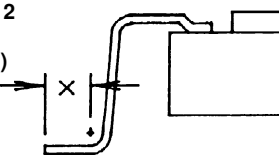

BOTTOM EXIT

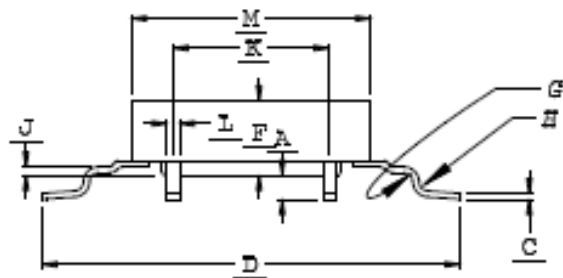

	DIM X	DIM Y	TOLERANCE
A	0.010	0.010	±0.002
C	0.006	0.006	±0.002
D	2.130	2.130	±0.010
E	0.040	0.040	±0.005
X	-----	-----	-----
F	0.150	0.150	±0.013
G	0.010	0.010	±0.002
H	0.010	0.010	±0.002
J	0.1095	0.1095	±0.013
K	1.713	1.713	<u>BSC</u>
L	0.0086	0.0086	<u>MAX</u>
M	1.900	1.900	<u>MAX</u>
PITCH	0.0197	0.0197	<u>BSC</u>
# OF LEADS PER SIDE	88	88	
TOTAL # OF LEADS	352		

LEADS TINNED:

YES
 NO

CONTROLLING UNITS:

METRIC
 INCHES X

PACKAGE TYPE: METAL

CERAMIC X
 PLASTIC
 GLASS SEAL

LEAD TYPE: FLAT

ROUND X
 UP 0-4°
 DOWN 0-4°