

# fancort Industries, Inc.

31 FAIRFIELD PLACE

WEST CALDWELL, N. J. 07006

(973) 575-0610

WWW.FANCORT.COM

FAX (973) 575-9234

## FLAT PACK SPECIFICATION SHEET

FA NUMBER \_\_\_\_\_

CUSTOMER \_\_\_\_\_

PART NUMBER ATMEL DP (FP28.4)

DATE \_\_\_\_\_

DRAWN BY FANCORT \_\_\_\_\_

CHECKED BY \_\_\_\_\_

PACKAGE TYPE

TOP BRAZE

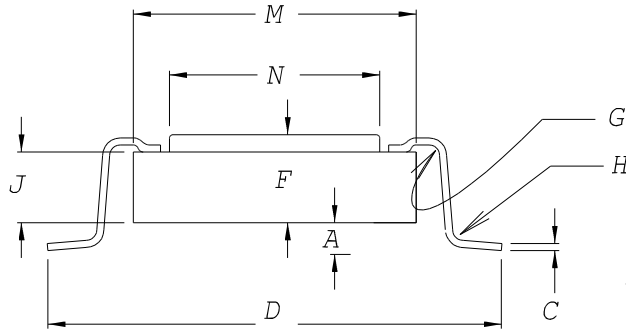

FOOT CONFIGURATIONS

SPRING BACK  
ANGLE 3°-7°

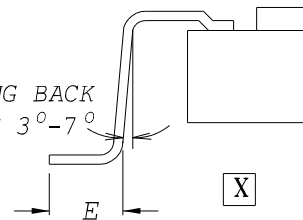

OPTION 1



SIDE EXIT

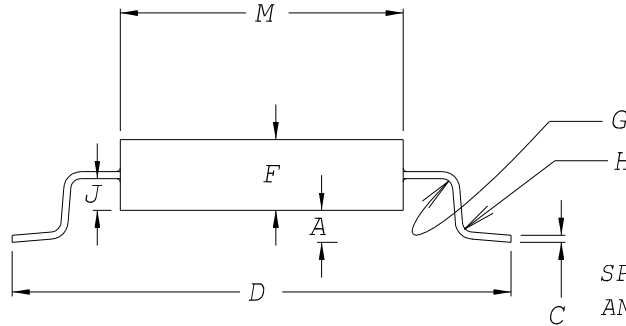

SPRING BACK  
ANGLE 3°-7°

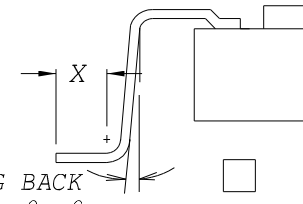

OPTION 2

JEDEC



BOTTOM EXIT

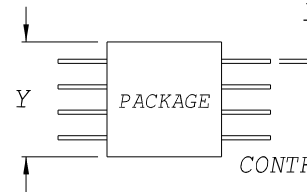
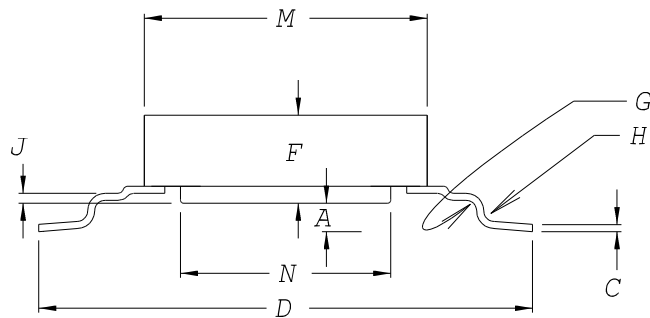

CUSTOMER SIGNATURE &  
DATE FOR ACCEPTANCE \_\_\_\_\_

CONTROLLING UNITS ARE [METRIC ] INCHES

LEADS TINNED  YES  NO

LEAD TYPE: FLAT

PACKAGE TYPE: METAL

ROUND

CERAMIC

TOE UP  0°-4°

PLASTIC

DOWN  0°-4°

GLASS SEAL

	DIM	+/-
A	.010	.002
C	.006	MAX
D	.630	.010
E	.050	.005
OPTION 1		
OPTION 2		
F	.130	MAX
G	.010	.002
H	.010	.002
J	.026	MIN
M	.420	MAX
N	.180	MIN
PACKAGE LENGTH	Y	.740 MAX
LEAD WIDTH	L	.019 MAX
PITCH		.050
# OF LEADS PER SIDE		14