

# fancort Industries, Inc.

31 FAIRFIELD PLACE

WEST CALDWELL, N. J. 07006

(973) 575-0610

WWW.FANCORT.COM

FAX (973) 575-9234

## QUAD PACK SPECIFICATION SHEET

FA NUMBER \_\_\_\_\_

CUSTOMER \_\_\_\_\_

PART NUMBER **AEROFLEX 68 LEAD QP**

DATE \_\_\_\_\_

DRAWN BY FANCORT \_\_\_\_\_

CHECKED BY \_\_\_\_\_

PACKAGE TYPE

TOP BRAZE

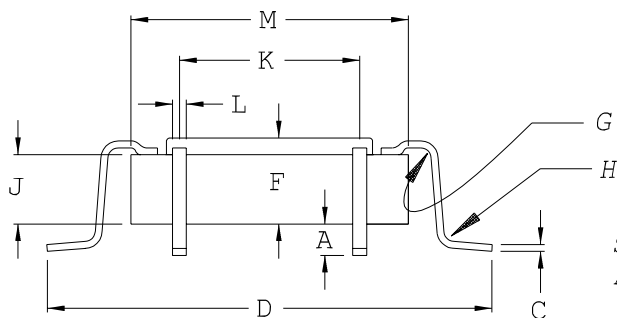

FOOT CONFIGURATIONS

SPRING BACK  
ANGLE 3°-7°

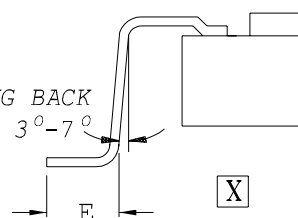

OPTION 1

OPTION 1

OPTION 2

	DIM X	DIM Y	TOLERANCE
A	.010	.010	.002
C	.008	.008	.002
D	1.210	1.210	.010
E	.050	.050	.005
F	.130	.130	MAX
G	.014	.014	.002
H	.014	.014	.002
J	.100	.100	.011
K	.796	.796	
L	.015	.015	TYP
M	.989	.989	MAX
PITCH	.050	.050	
# OF LEADS PER SIDE	17	17	
TOTAL # OF LEADS	68		

SIDE EXIT

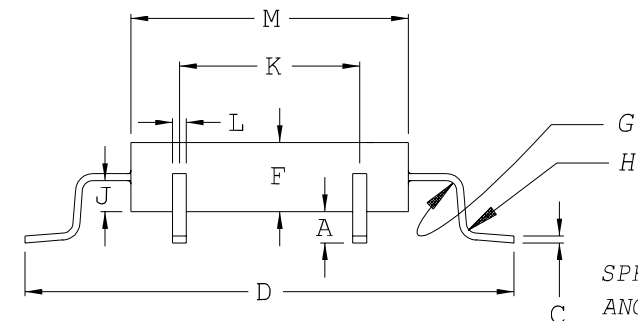

SPRING BACK  
ANGLE 3°-7°

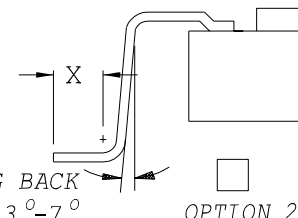

OPTION 2  
JEDEC

BOTTOM EXIT

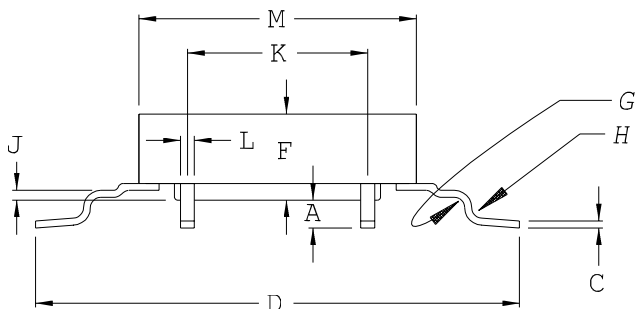

CUSTOMER SIGNATURE &  
DATE FOR ACCEPTANCE \_\_\_\_\_

CONTROLLING UNITS ARE [METRIC ] INCHES

LEADS TINNED  YES  NO

LEAD TYPE: FLAT

PACKAGE TYPE: METAL

ROUND

CERAMIC

TOE UP  0°-4°

PLASTIC

DOWN  0°-4°

GLASS SEAL